



Level 2



Focus on Horticulture maths quiz

Below is a plan of a section of garden at a retirement home. The path continues either side of the plan, but the residents just want this section replacing and planting up with the plants shown.

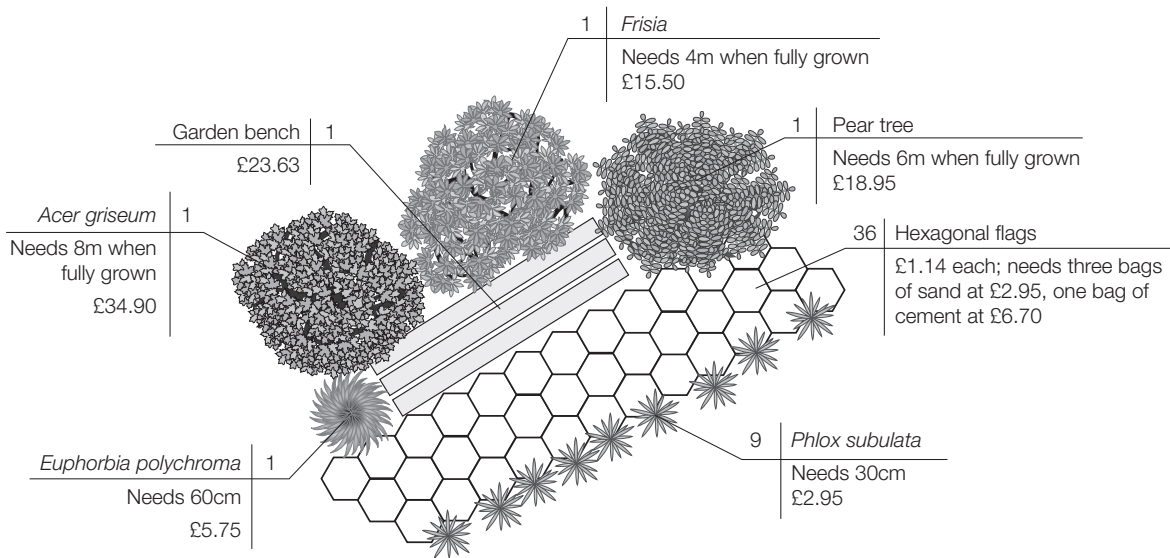

Phlox subulata: Creeping Phlox

A rapidly spreading perennial
Creeping Phlox grows no more than six inches in height. The flowers are quite brilliant
This plant looks great growing over rocks

Euphorbia polychroma: Cushion Spurge

Beautiful plant in early spring
Pale green leaves give way to shiny yellow bracts, which resemble pin-cushions

Pear tree

Large, juicy, rich flavoured pears.
Pick from mid August.
The tree needs full sun.

Frisia

One of the most popular ornamental trees.
Frisia has golden foliage that gets brighter and more yellow right up to the autumn.

Acer Griseum: Paper-bark maple

A tree that has peeling, papery, cinnamon-brown bark and red leaves in the autumn.
Annual growth rate is less than 30 centimetres.



e-mail: move-on@ctad.co.uk

www.move-on.org.uk

tel: (01223) 470480

1 You pay for the hexagonal flags and the materials for laying them. How much have you spent?

- A £45.55
- B £56.59
- C £15.55
- D £39.90

Answer:

2 The retirement home has a maximum budget of £250 to spend on the hexagonal flags, the sand and cement and the cost of labour for laying the path. Approximately what proportion of their budget have you spent so far?

- A 78%
- B 25%
- C 22%
- D 31%

Answer:

3 You need an idea of the size of the hexagonal flags for storage purposes. The perimeter of each flag is 1.2m long. What is the length of one side?

- A 25 cm
- B 20 cm
- C 30 cm
- D 35 cm

Answer:

4 You negotiate a deal with the builders' merchant, who offers you a choice of either a 20% reduction or £10 off for the flags, sand and cement. What is the difference between these two offers?

- A £1.07
- B £11.70
- C £10.90
- D £1.31

Answer:

5 You have everything you need for the path, except someone to do the work! The builders' merchant recommends a labourer who charges £17 an hour. He reckons it takes nine minutes on average to lay a flag. What will be the labour cost for laying the whole path?

- A £17
- B £79
- C £91.80
- D £91.65

Answer:



6 What is the total amount you need to spend on plants and trees?

- A £115.94
- B £183.93
- C £101.65
- D £142.33

Answer:

7 The owner of the garden centre, from where you bought the plants, the trees and the bench, gave you 15% off for buying so many things. How much did you spend at the garden centre?

- A £115.83
- B £106.48
- C £132.35
- D £139.40

Answer:

8 Which plant or tree represents the best value for money given its cost and eventual height?

- A Pear
- B Frisia
- C Acer Griseum
- D Phlox Subulata

Answer:

9 The annual growth rate of the Acer Griseum is 30 cm. Approximately how long will it take to reach its full height?

- A 14 years
- B 20 years
- C 26 years
- D 8 years

Answer:

